

LEGEND

- 12.0

12.0

SWD

S

W
- EXISTING SURFACE CONTOURS
- DESIGNED SURFACE CONTOURS
- STAGE BOUNDARY
- PROPOSED STORMWATER DRAINAGE PIPE
- PROPOSED SIDE ENTRY PIT (REFER LONG SECTION DRAWINGS FOR NO. OF BAYS & CHAMBER SIZE)
- PROPOSED STORMWATER DRAINAGE PIT
- PROPOSED SEWER
- PROPOSED WATER MAIN
- PROPOSED ROAD CENTRE LINE
- PROPOSED LAYBACK KERB & GUTTER. REFER DETAIL ON DRG. 3B\_C300.
- PROPOSED STREETLIGHT

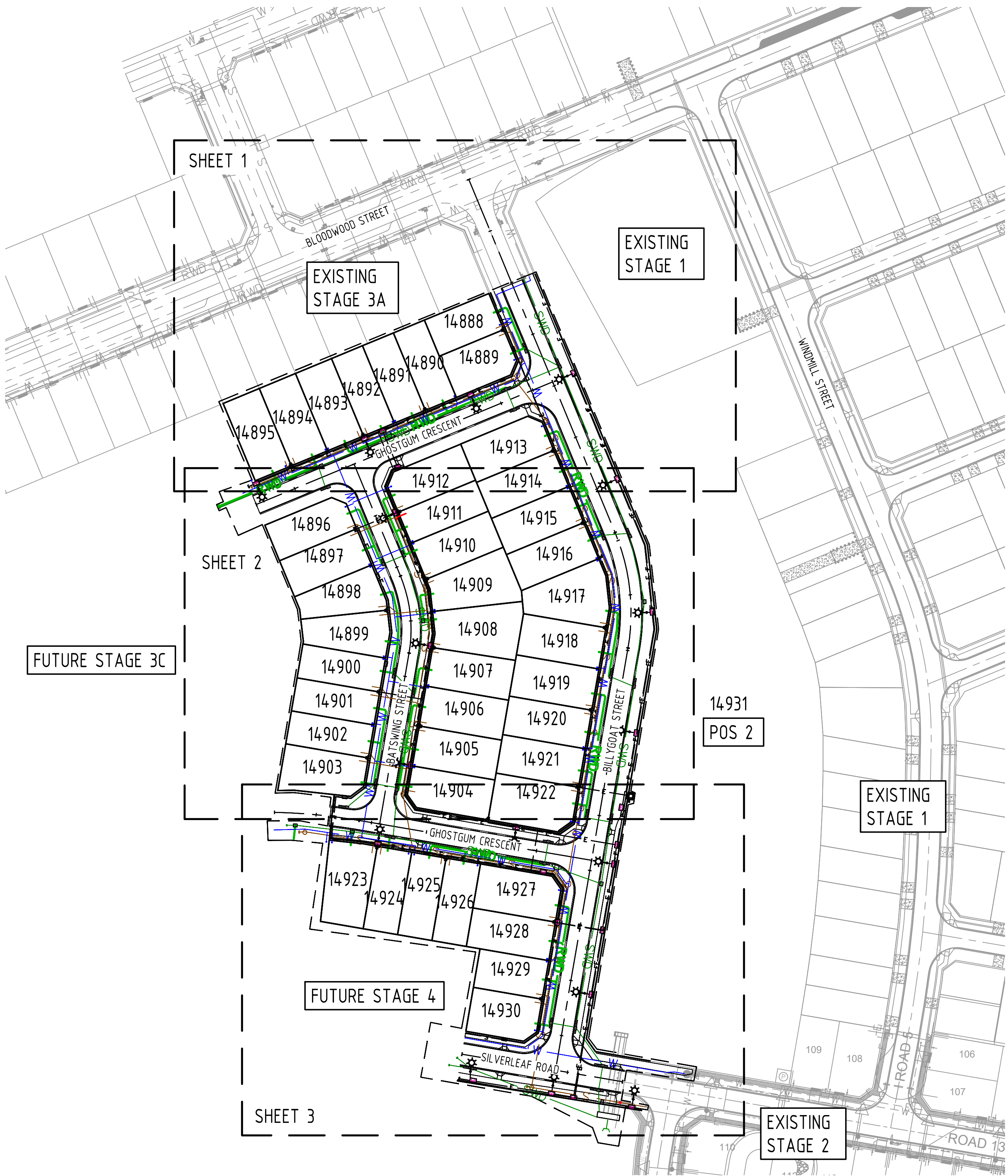
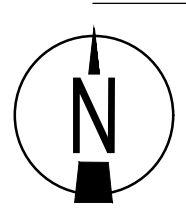

STAGE 3B LAYOUT  
SCALE 1:1000

AS-CONSTRUCTED

THE 'AS-CONSTRUCTED' INFORMATION SHOWN ON THIS DRAWING HAS BEEN BASED OFF AS-CONSTRUCTED INFORMATION PROVIDED BY OSTOJIC GROUP. IT IS ASSUMED THAT ALL INFORMATION IS IS ACCURATE AND CORRECT.

PERMISSION TO USE FOR CONSTRUCTION PURPOSES  
ROADWORKS AND STORMWATER DRAINAGE

SIGNED \_\_\_\_\_ DATE \_\_\_\_\_

DIRECTOR CITY GROWTH AND OPERATIONS - CITY OF PALMERSTON

This permission to use is given on the basis that the Developer and/or Consultant is not absolved from full responsibility for the correctness and accuracy of the design and/or documents associated. This permission is valid for two years from date of signing.

AS CONSTRUCTED

Rev	Date	Description	By	Chk
2	25.02.22	AS CONSTRUCTED	SM	JL
1	23.02.22	AS CONSTRUCTED	JL	SW
0	28.07.21	ISSUED FOR CONSTRUCTION	SM	JL

0 10 20 30 40 50m  
SCALE 1:1000  
AT ORIGINAL SIZE (A1)



**Darwin Office**  
Suite G01, Manunda Place, 38 Cavenagh Street,  
Darwin, Northern Territory 0800, Australia  
GPO Box 2422, Darwin, Northern Territory 0801  
T 1300 657 402 F +617 3871 2266  
E info@adgce.com W www.adgce.com  
BRISBANE / DARWIN / GOLD COAST / MELBOURNE / PERTH /  
SUNSHINE COAST / SYDNEY / TOOWOOMBA

Client:  
COSTOJIC PTY LTD

Project Name  
ZUCCOLI ASPIRE  
STAGE 3B  
CIVIL WORKS

Discipline  
CIVIL

Designed By  
JMB

Project No.  
20696

Checked By  
SW

Drawn By  
JMB

Status  
CONSTRUCTION

Approved By  
SW

Scale at A1  
1:1000

Title  
STAGE 3B  
OVERALL LAYOUT PLAN

Drawing No.  
3B\_002

Revision  
2